

Existing Site Plan - 1:1250

North

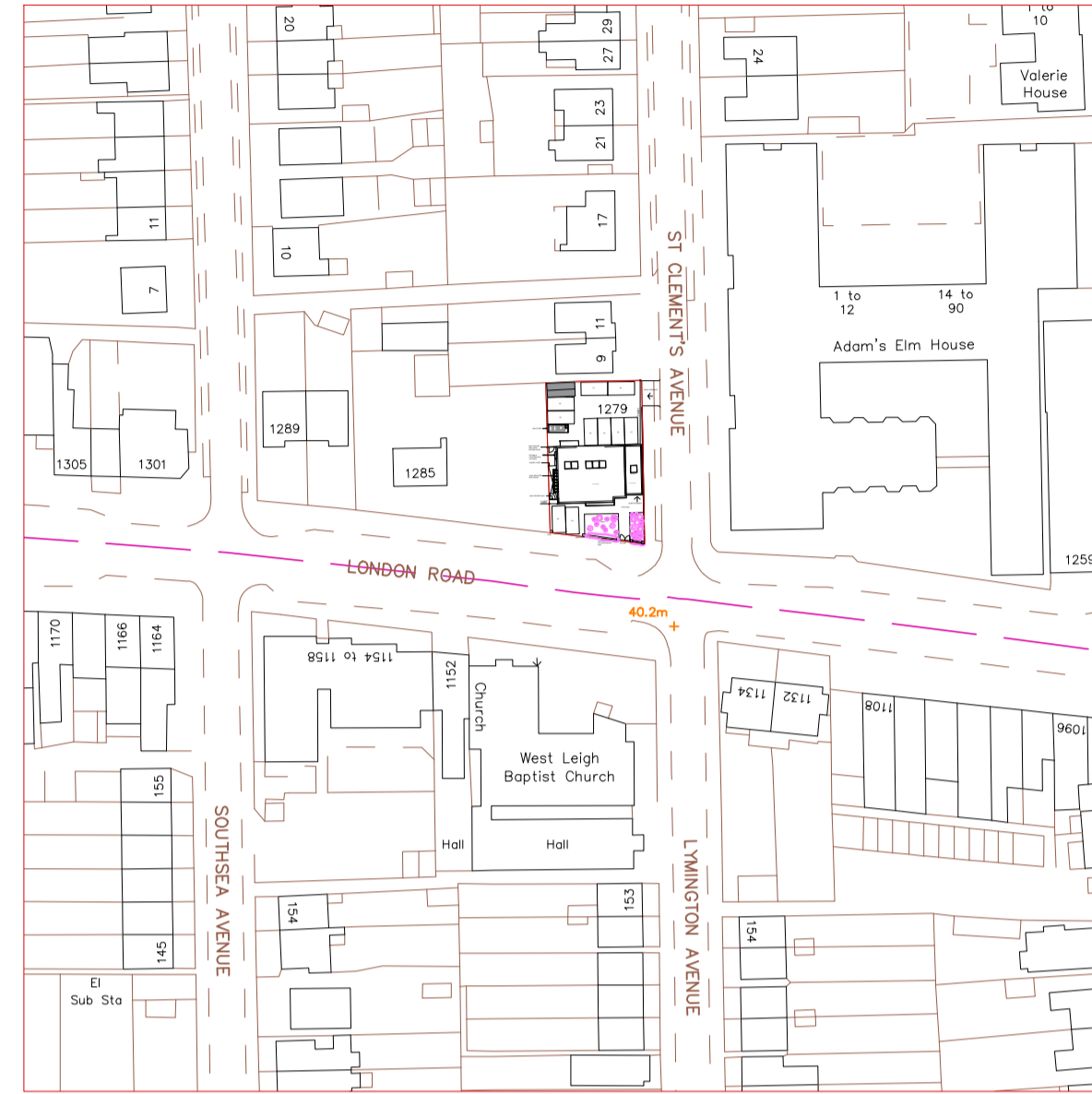

Proposed Site Plan - 1:1250

North

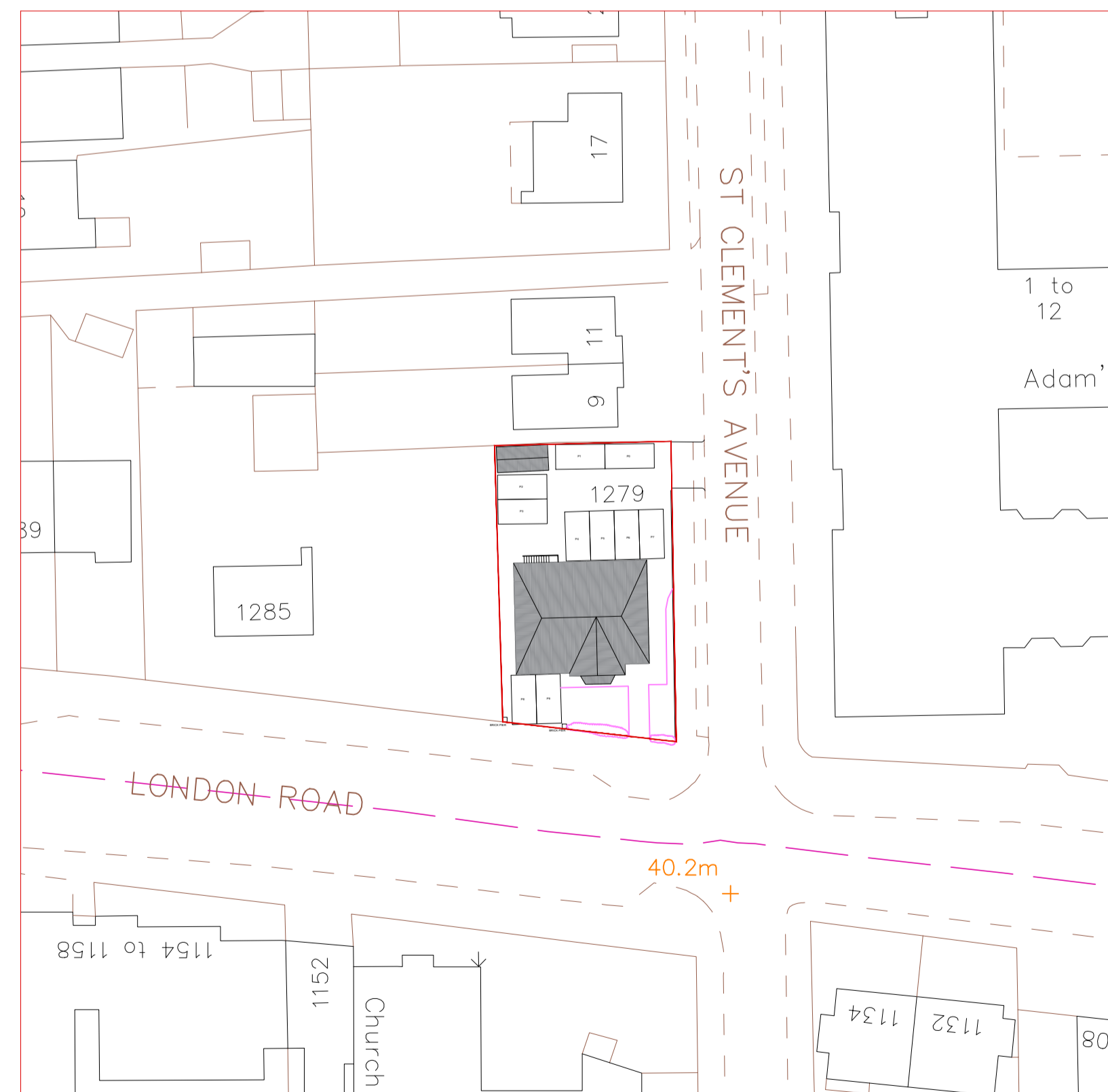

Existing Block Plan - 1:500

North

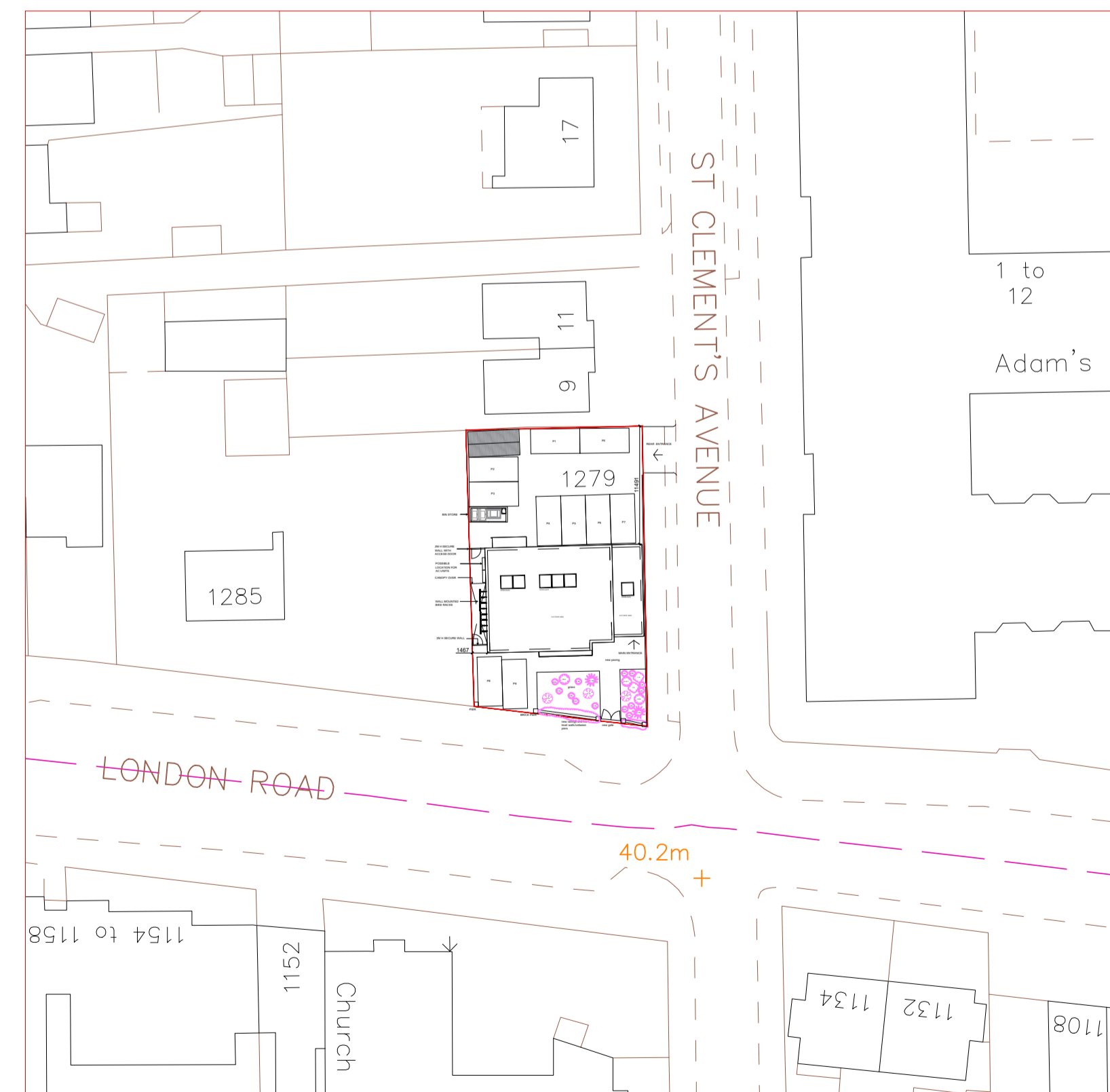

Proposed Block Plan - 1:500

North

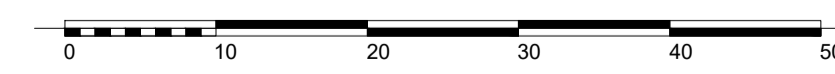

Notes:

Rev	Comment	By	Date
C	CROSSOVER AS EXISTING	DS	05/12/18
B	PLANNING ISSUE	DS	19/10/18

Stage:
1 - Stage

Client:
NICK HYDE, JAMES HYDE

Project:
FORRESTER HYDE
1279 LONDON ROAD
LEIGH-ON-SEA
SOUTHEND ON SEA S89 2AD
ESSEX

Drawing Title:
SITE AND BLOCK PLANS

Drawing no:	S28_P102	Revision:	C
Project no:	S28-08-18	Drawn by:	DS
Scale:	1:500, 1:1250 @ A1	Checked by:	MM

SKARCHITECTS
853-855 London Road
Westcliff-on-Sea
SS0 9SZ
Tel: 01702 509259
Email: info@skarchitects.co.uk

Do not scale from this drawing.
Drawing to be read in conjunction with all other issued drawings, documents and relevant construction information.
All information on this drawing is for guidance purposes only. All dimensions must be checked on site.
This information is subject to Building Control requirements and the requirements of all relevant statutory authorities and service providers.
© SKArchitects Ltd 2018